



Truma AquaGo™ LP Gas Instant Water Heater

Model: Truma AquaGo™ basic (DLE60B) *
Truma AquaGo™ comfort (DLE60C) *
Truma AquaGo™ comfort plus (DLE60CP) *

* Patent Pending

⚠ WARNING

If the information in these instructions is not followed exactly, a fire or explosion may result, causing property damage, personal injury, or death.

– Do not store or use gasoline or other flammable vapors and liquids in the vicinity of this or any other appliance.

WHAT TO DO IF YOU SMELL GAS

- Evacuate all persons from the vehicle.
- Shut off the gas supply at the gas container or source.
- Do not touch any electrical switch, or use any phone or radio in the vehicle.
- Do not start the vehicle's engine or electric generator.
- Contact the nearest gas supplier or certified service technician for repairs.
- If you cannot reach a gas supplier or certified service technician, contact the nearest fire department.
- Do not turn on the gas supply until the gas leak(s) has been repaired.

Installation and service must be performed by a certified service technician, service agency, or the gas supplier.

en-US **Operating instructions** Page 2
Installation instructions Page 16
To be kept in the vehicle.
This document is part of the water heater.



Conforms to ANSI Std Z21.10.3
Certified to CSA Std 4.3

Sales and Service

Truma Corp.
825 East Jackson Blvd.
Elkhart, IN 46516
USA
Toll Free 1-855-558-7862
Fax 1-574-538-2426
info@trumacorp.com
www.truma.net



Overview / Designation of parts

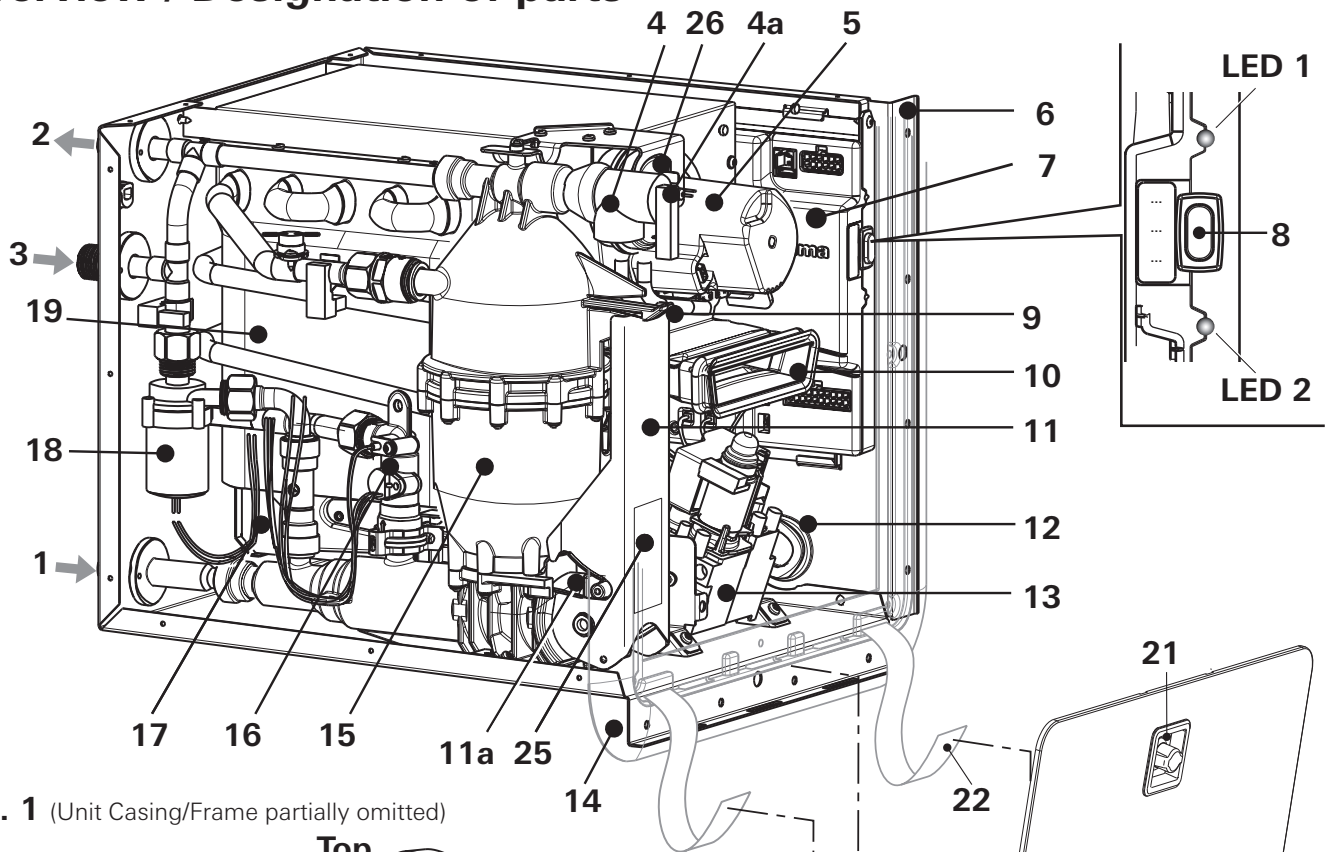

Fig. 1 (Unit Casing/Frame partially omitted)

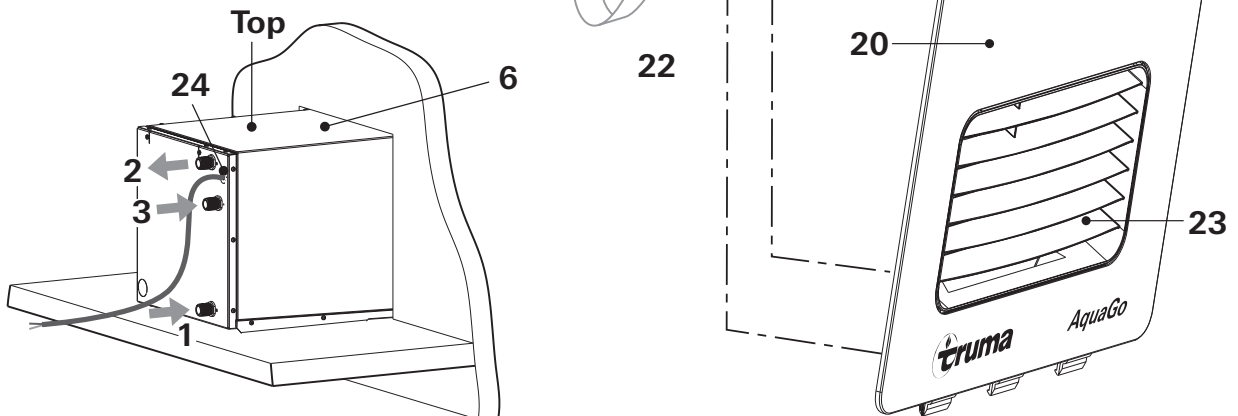

Fig. 2 (rear view of appliance)

Legend

- | | |
|---|--|
| 1 Cold water connection 1/2" NPT | 14 Cover plate |
| 2 Hot water connection 1/2" NPT | 15 Temperature stabilizer |
| 3 Circulation line connection 1/2" NPT
(AquaGo™ comfort plus model only) | 16 Water flow sensor |
| 4 Pressure relief valve | 17 Burner |
| 4a Test lever | 18 Circulation pump (AquaGo™ comfort
and AquaGo™ comfort plus models) |
| 5 Flue fan | 19 Heat exchanger |
| 6 Unit casing | 20 Access door (assembly) |
| 7 Control unit | 21 Turn lock |
| 8 Mode switch | 22 Webbing |
| 9 Latch | 23 Venting grid (air inlet, exhaust) |
| 10 Flue duct | 24 Grommet for 12 V cable
(power supply) |
| 11 Easy Drain Lever | 25 Type plate |
| 11a Water inlet filter | 26 Exhaust pressure switch |
| 12 Gas pipe grommet | LED 1 Power ON LED – green |
| 13 Gas valve | LED 2 Error code LED – red |

California Proposition 65 lists chemical substances known to the state to cause cancer, birth defects, death, serious illness, or other reproductive harm. This product may contain such substances or such substances may be formed from combustion of fuel (gas) or be components of the product itself.

Table of Contents

Overview / Designation of parts	2
Intended use	3
Prohibited use	3

Consumer Safety Information

Safety symbols and signal words	4
Safety behavior and practices	4
Safety features	5

Operating Instructions

How the Truma AquaGo™ instant water heater works ..	5
Pressure relief valve	6
Access door	7
Opening the access door	7
Removing the access door	7
Closing the access door	7
Placing Truma AquaGo™ instant water heater in operation	8
Inspections before each use	8
Operating procedures	8
Operating modes	9
Switching off the Truma AquaGo™ instant water heater	9
Winter operation	10
Winterizing	10
Optional: Winterizing the RV with a winterizing fluid	10
AquaGo™ technical data	11
“AquaGo” MANUFACTURER LIMITED WARRANTY	11
Maintenance	12
Draining the water and cleaning the water inlet filter	12
Decalcifying	13
Troubleshooting	14

Installation Instructions

Safety behavior and practices	16
Selecting a suitable location	16
Preparing for installation	17
Connection diagrams	19
Model AquaGo™ basic / AquaGo™ comfort	19
Model AquaGo™ comfort plus	20
Electrical connection for all models	20
Installing the Truma AquaGo™ instant water heater	21
Connecting the gas line	22
Functional check	23
APPENDIX A – Error Codes	25
APPENDIX B – Functional Diagram	26
APPENDIX C – Spare Parts (all models)	27
APPENDIX D – Electrical Connection Diagram	28

Intended use

The Truma AquaGo™ instant water heater may be used only to heat tap water in Recreational Vehicles (RVs) that are used for recreation, travel, or camping.

RVs are recreational vehicles designed as temporary living quarters for recreation, camping, or travel use. Such vehicles have their own power or are towed by another vehicle.

Prohibited use

Any use other than the intended use (see above) is prohibited.

Examples of prohibited use:

- Use in a marine environment.
- Use as part of a space heating system.
- Use in mobile homes.
- Use in food trucks or roadside food vending vehicles.
- Use in construction trailers.

Consumer Safety Information

Safety symbols and signal words

⚠ This is the safety alert symbol. This symbol alerts you to potential hazards that can kill or hurt you and others.

⚠ DANGER indicates a hazardous situation which, if not avoided, will result in death or serious injury.

⚠ WARNING indicates a hazardous situation which, if not avoided, could result in death or serious injury.

⚠ CAUTION indicates a hazardous situation which, if not avoided, could result in minor or moderate injury.

NOTICE is used to address practices not related to physical injury.

i Other important information or tips

Safety behavior and practices

Ensuring a safe operating environment

- Danger of suffocation! To ensure dissipation of exhaust gases, operate the Truma AquaGo™ instant water heater outdoors only. Never use in enclosed spaces or tents or breathe in the exhaust gases.
- Use the Truma AquaGo™ instant water heater only with a functional LP gas and carbon monoxide detector installed in the RV. For installation, operation and function test follow the manufacturer's guidelines.
- Keep the area around the Truma AquaGo™ instant water heater free from combustible materials, gasoline, and other flammable vapors or liquids.
- Keep the air inlet and exhaust outlet free of obstructions in order to ensure clean combustion. Do not lean any objects against the water heater's access door or place any foreign objects within 2 feet (61 cm) of the access door.

Responsibilities of the operator

- Avoid possible serious health issues caused by electromagnetic radiation. All persons with a pacemaker are prohibited from opening the access door and maintaining the water heater during operation in ON, ECO ON or ON Comfort mode.

- The operator is responsible for the water filled into the Truma AquaGo™ instant water heater and its quality.

Safe operation

- Use with LP gas (propane) only. Butane or any mixtures containing more than 10% butane shall not be used.
 - LP tanks must be filled by a qualified gas supplier only.
- Hot water can be dangerous, especially for infants, children, the elderly, or infirm. It can cause severe burns. Therefore:
 - Never actuate the pressure relief valve (Fig. 1 – 4) as long as the Truma AquaGo™ instant water heater is still hot.
 - Never actuate the Easy Drain Lever (Fig. 1 – 11) as long as the Truma AquaGo™ instant water heater is under water pressure and/or still hot.
 - Always check the water temperature before entering a shower or bath.
- How long before hot water causes skin damage?

Temperature °F (°C)	Time before skin becomes scalded
155 (68)	1 second
148 (64)	2 seconds
140 (60)	5 seconds
133 (56)	15 seconds
127 (52)	1 minute
124 (51)	3 minutes
120 (48)	5 minutes
100 (37)	safe bathing temperature

Source: Moritz, A.R. / Herriques, F.C.: Studies of thermal injuries: the relative importance of time and surface temperature in causation of cutaneous burns

A. J. Pathol 1947; 23: 695 - 720

Safe operation while moving the RV

- To avoid damage, make sure the access door (Fig. 1 – 20) to the Truma AquaGo™ instant water heater is closed before moving the RV, as follows:
 - Turn lock is engaged.
 - Access door is flush with the cover plate.
- Shut OFF gas and the LP tank when moving the RV. This disables all gas appliances and pilot lights. Gas appliances may never be operated while vehicle is in motion.
- Shut OFF the Truma AquaGo™ instant water heater when refueling or pumping gas.
- To avoid damage, make sure no spray water enters the Truma AquaGo™ instant water heater when cleaning the RV, e.g., do not spray directly into the openings/venting grid.

Safe handling of malfunctions

- Switch OFF the gas supply and the Truma AquaGo™ instant water heater:
 - if anything seems to be out of the ordinary.
 - if you smell gas.

Safe maintenance and repair

- Only use approved substances to decalcify the Truma AquaGo™ instant water heater to avoid damage and the voiding of your warranty. Never use vinegar. Call your local AquaGo™ dealer or service provider or see www.truma.net for more information.
 - The use of non-Truma-approved substances for decalcification can cause chemical reactions and produce hazardous substances that could enter the drinking water.
- Any alteration to the Truma AquaGo™ instant water heater or its controls can cause unforeseen serious hazards and will void the warranty.
- After a long period of winterization: Flush all hot/cold water hoses and the Truma AquaGo™ instant water heater thoroughly with drinking water before using it.

Safety features

The Truma AquaGo™ instant water heater is equipped with the following safety devices:

Flame monitoring

If the flame goes out, the gas supply is switched off.

Low-voltage shutdown

If the voltage drops below 10 V DC, the gas supply to the burner is switched off.

Overcurrent protection

If there is a short circuit in the Truma AquaGo™ instant water heater (>10 A), a fuse on the control unit is activated and the Truma AquaGo™ instant water heater is switched off.

Monitoring of the flue fan

If there is a failure of the flue fan, the gas supply to the burner is switched off.

Monitoring of hot water temperature

A water over temperature switch avoids excessively high water temperatures.

Operating Instructions

Read and follow the “Consumer Safety Information” before operating the Truma AquaGo™ instant water heater.

▲ WARNING

Scalding injuries caused by hot water!

Water temperatures over 127°F (52°C) can cause severe burns or scalding and in extreme cases even death.

- Before using hot water faucet or using the shower, allow the hot water to run until the water temperature no longer increases.
- Test the temperature of the water before placing a child in the bath or shower.
- Do not leave a child or an infirm person in the bath unsupervised.

How the Truma AquaGo™ instant water heater works

The Truma AquaGo™ instant water heater was developed exclusively for use in Recreational Vehicles (RVs).

The Truma AquaGo™ instant water heater is connected between the vehicle's fresh water supply and its hot water plumbing system. It is powered by propane and a 12 V power supply. The ventilation grid on the access door allows combustion air to flow into the appliance and exhaust gas to flow out.

The water pressure on the inlet side must be limited to 65 psi (4.5 bar), if necessary with a water pressure regulator.

When the Truma AquaGo™ instant water heater is switched on, the tap water will be warmed on-demand:

- A volume-flow sensor in the Truma AquaGo™ instant water heater detects when the hot water faucet has been opened and the volume flow is greater than approximately 0.4 gallons/min (1.5 liter/min). The burner then starts automatically.
- The burner control continuously adjusts the heater output based on volume flow and inlet water temperature, so that the temperature at the hot water outlet is approximately 120 °F (49 °C). A temperature stabilizer is also installed in the Truma AquaGo™ instant water heater to minimize fluctuations of the outlet temperature.

- After some time the maximum temperature at the faucet or in the shower is reached. The length of time will depend on the model (AquaGo™ basic, AquaGo™ comfort and AquaGo™ comfort plus) and variations in the water plumbing (length of pipes, insulation, circulation line, etc.). Like in a home shower, a comfortable water temperature at the shower head is reached by mixing in cold water.
- When the volume flow is less than approximately 0.4 gallons/min (1.5 liter/min) and the faucet is closed, the burner is automatically switched back off.

The AquaGo™ comfort and AquaGo™ comfort plus models are equipped with a circulation pump. The circulation pump as well as the burner are switched on automatically by the control unit in order to keep the water temperature above a certain level (102 °F (39 °C) in "Comfort" mode and 41 °F (5 °C) in "ECO" mode).

The AquaGo™ comfort and AquaGo™ comfort plus models permit operation without the risk of freezing even at temperatures of -4 °F (-20 °C).



- Only the Truma AquaGo™ instant water heater will be protected from freezing. Cold water lines, the water tank and the external water valves may freeze. The vehicle must be heated separately.

A constant supply of power (12 V), propane gas, and water is needed during low-temperature operation.

To conserve gas and power, use the "ECO ON" switch position. This will maintain a temperature above 41 °F (5 °C) in the Truma AquaGo™ instant water heater. For maximum comfort (rapid availability of hot water at the faucet), use the "ON Comfort" switch position. This will maintain a temperature above 102 °F (39 °C) in the appliance.

The AquaGo™ basic model does not have frost protection and shall therefore not be used or filled with water when there is a danger of freezing.

Pressure relief valve

⚠ WARNING

Scalding injury from hot water and/or tampering with the pressure relief valve!

- Never actuate the pressure relief valve as long as the Truma AquaGo™ instant water heater is still hot.
- Do not place a plug or reducing coupling on the outlet part of the valve.



- The pressure relief valve is a safety component and shall not be removed for any reason other than replacement.
- The pressure relief valve is not serviceable; if defective it must be replaced. Replacement shall be performed by a certified service technician.
- Tampering with the pressure relief valve will void the warranty.

The Truma AquaGo™ instant water heater is equipped with a pressure relief valve (Fig. 3) that complies with the standard for Relief Valves for Hot Water Supply Systems, ANSI Z21.22

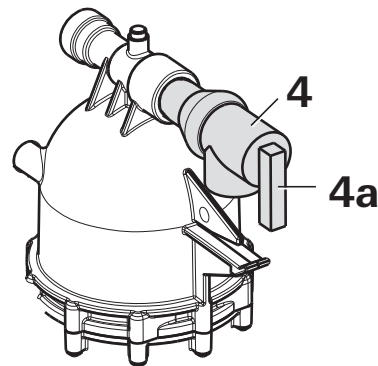

Fig. 3

- 4 Pressure relief valve
- 4a Test lever

Access door

Opening the access door

1. Turn the turn lock counterclockwise ↺ into the vertical position.

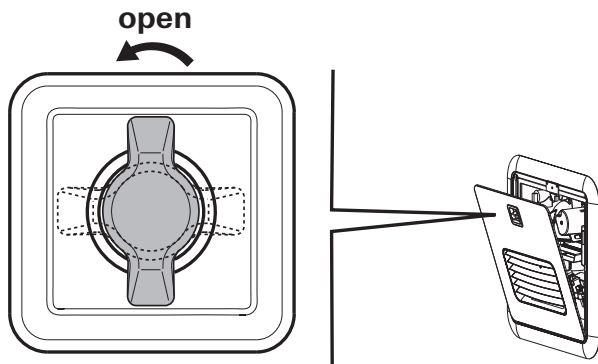

Fig. 4

i Hint!

- The access door can be opened to two different positions:
 - Position ① is the maximum opening width for switching the Truma AquaGo™ instant water heater on or off.
 - Position ② is the starting position for removing the access door.

NOTICE

Damage to the hinge!

- Do not try to remove the access door in Position ①. Position ① is the maximum opening width of the access door.
- Only remove the access door in Position ②.

2. Open the access door to Position ①.

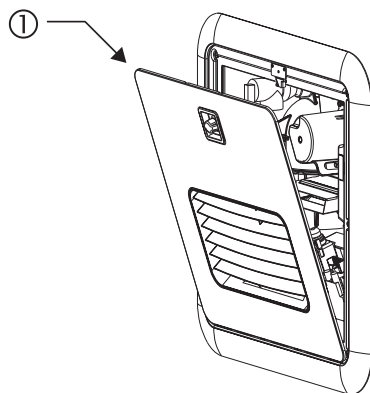

Fig. 5

Removing the access door

1. Open the access door to Position ②.
2. Move the access door upwards to remove it.

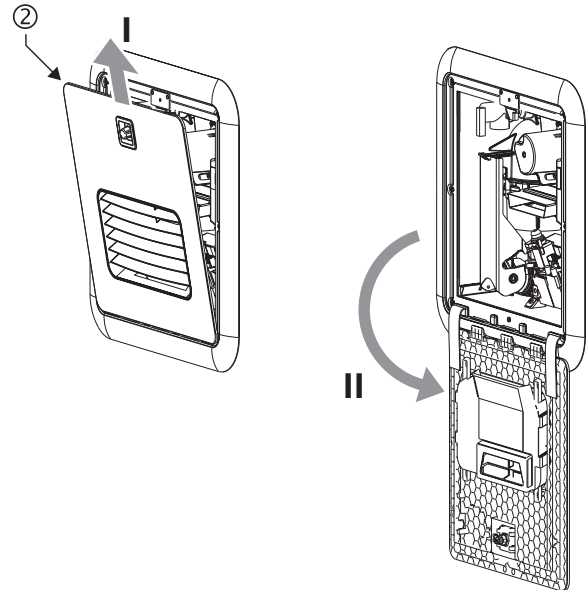

Fig. 6

Closing the access door

NOTICE

Damage to the access door and the RV if the access door is not closed properly!

- Make sure that the access door is flush with the cover plate when closed.

1. If removed, insert the access door into the cover plate.
2. Make sure that the webbing is not pinched between the access door and the cover plate.
3. Press the access door against the cover plate.
4. Turn the turn lock clockwise ↻ into the horizontal position.

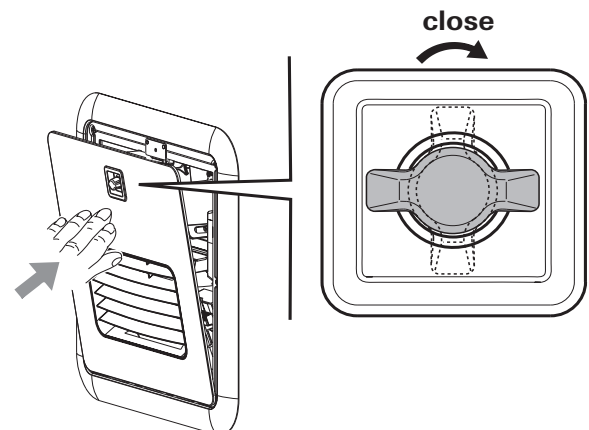

Fig. 7

Placing Truma AquaGo™ instant water heater in operation

▲ WARNING

Danger of over-temperature and toxic exhaust gases!

- Use with LP gas (propane) only. Butane or any mixtures containing more than 10 % butane shall not be used.
- Keep the air inlet and exhaust gas outlet free of obstructions. Do not lean any objects against the water heater's access door or place any foreign objects within 2 feet (61 cm) of the access door.

▲ WARNING

Danger of combustion, personal injury and damage to RV!

- Keep the area around the Truma AquaGo™ instant water heater free from combustible materials, gasoline, and other flammable vapors or liquids.
- Switch the gas supply and the Truma AquaGo™ instant water heater off:
 - if anything seems to be out of the ordinary.
 - if you smell gas.
 - if you move the RV.
 - before entering a gas station.
 - before entering a tunnel.

Inspections before each use

Check the Truma AquaGo™ instant water heater for the following points before each use. In case of damage, contact an authorized Truma service provider and do not operate the Truma AquaGo™ instant water heater.

1. Check for visible damage, e.g., on the cover plate or access door.
2. Access to adequate quantities of LP gas (Fuel inlet pressure 10.5" – 14" wc (26.2 – 34.9 mbar)), 12 V power, and water must be available.
3. The access door must be closed.
4. Keep the Truma AquaGo™ instant water heater free of foreign objects, e.g., leaves, animals, spiderwebs, and keep the area around free of snow and ice. The Truma AquaGo™ instant water heater will not function properly if the intake air or exhaust terminal is obstructed.

Operating procedures

Proceed as follows to fill the Truma AquaGo™ instant water heater with water:

1. Close open bypass lines (if present).
 2. Turn on fresh water supply or switch on water pump.
 3. Fill the plumbing system.
 - Open all water-release points, e.g., cold and hot water faucets, showers, toilets.
 - Once water flows, the plumbing system is ventilated. Close the water-release points.
- Place the Truma AquaGo™ instant water heater into operation as follows:
4. Make sure that the LP gas supply is turned on.
 5. Switch on the 12 V power supply.
 6. Open the access door (refer to "Opening the access door" on page 7).
 7. Switch on the Truma AquaGo™ instant water heater at mode switch. Refer to "Operating modes" on page 9 for modes available with your model.
 8. Close the access door (refer to "Closing the access door" on page 7).

▲ WARNING

Scalding injuries caused by hot water!

Water temperatures over 127°F (52°C) can cause severe burns or scalding and in extreme cases even death.

- Before using hot water faucet or using the shower, allow the hot water to run until the water temperature no longer increases.
- Test the temperature of the water before placing a child in the bath or shower.
- Do not leave a child or an infirm person in the bath unsupervised.

i

- There may be a variation between the temperature delivered from the Truma AquaGo™ instant water heater and the temperature at the faucet due to water conditions or the length of pipe from the Truma AquaGo™ instant water heater.
- The presence of a flow restrictor in the hot water line may limit the water flow.

9. How to use hot water:
 - To obtain the desired water temperature at the faucet or in the shower, mix cold and hot water.
 - Particularly when showering, wait until the water temperature has stabilized before entering or allowing other people or animals to enter the shower.

Operating modes

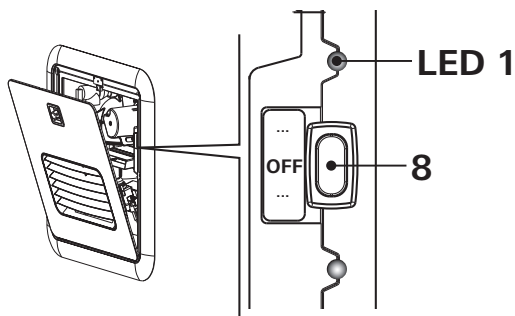

Fig. 8

AquaGo™ basic model



- Both ON positions on the mode switch have the same function. Choose your preferred position.

Operating mode	Description
	<ul style="list-style-type: none"> • Green LED 1 is illuminated. • The Truma AquaGo™ instant water heater is switched on. • Water temperature at outlet is approximately 120 °F (49 °C).

AquaGo™ comfort / AquaGo™ comfort plus models

Operating mode	Description
	<ul style="list-style-type: none"> • Green LED 1 is illuminated. • The Truma AquaGo™ instant water heater is switched on. • Water temperature at outlet is approximately 120 °F (49 °C). • Prevention of freezing: The temperature in the Truma AquaGo™ instant water heater is automatically held above 41 °F (5 °C). • Energy-saving mode

Operating mode	Description
	<ul style="list-style-type: none"> • Green LED 1 is illuminated. • The Truma AquaGo™ instant water heater is switched on. • Water temperature at outlet is approximately 120 °F (49 °C). • Standby heat: The temperature in the Truma AquaGo™ instant water heater is automatically held above 102 °F (39 °C). • Rapid availability of hot water.

Switching off the Truma AquaGo™ instant water heater

1. Open the access door (refer to “Opening the access door” on page 7).
2. Switch off the Truma AquaGo™ instant water heater at mode switch (Fig. 8).

Model

AquaGo™ basic	AquaGo™ comfort / AquaGo™ comfort plus

3. The green LED 1 extinguishes.
3. Close the access door (refer to “Closing the access door” on page 7).
4. If the Truma AquaGo™ instant water heater is not needed anymore, turn off the LP gas supply.



- If you intend to place the RV into storage or turn off the Truma AquaGo™ instant water heater during freezing temperatures, refer to “Winterizing” on page 10.

Winter operation

(AquaGo™ comfort / AquaGo™ comfort plus models only)

The Truma AquaGo™ instant water heater has a built-in thermostat that will start the burner and the circulation pump whenever the temperature in the Truma AquaGo™ instant water heater falls below 41 °F (5 °C). The burner will automatically shut off when it senses a temperature above 111 °F (44 °C).



- For the Truma AquaGo™ instant water heater to operate properly at all times under potentially freezing conditions, you must have sufficient LP gas (fuel inlet pressure 10.5" – 14" wc (26.2 – 34.9 mbar)) in the tank, sufficient water in the system, and you must leave the Truma AquaGo™ instant water heater powered with the mode switch in the ECO ON or ON Comfort position.
- Winter operation will not protect the RV's entire plumbing system. The RV must be designed for winter use/freezing conditions.

Winterizing

NOTICE

Severe damage to the plumbing components and the Truma AquaGo™ instant water heater!

Any damage caused by freezing or an unsuitable winterizing fluid will not be covered by warranty.

- Follow the recommendations below if the Truma AquaGo™ instant water heater will be stored under freezing conditions or for an extended period of time.
- Winterize the Truma AquaGo™ instant water heater at the start of the winter season or before traveling to a location where freezing conditions are likely.

To winterize the Truma AquaGo™ instant water heater, drain all water from the appliance (refer to "Draining the water and cleaning the water inlet filter" on page 12).

Once the water has been drained, the Truma AquaGo™ instant water heater is protected against freezing conditions.

Optional: Winterizing the RV with a winterizing fluid



- Winterizing the RV with a winterizing fluid is only possible with an installed bypass kit (not scope of supply) (refer to "Connection diagrams" on page 19).
- Refer to the connection diagram for all letters referred to in the following description.

Winterizing models

AquaGo™ basic / AquaGo™ comfort

1. Close valves A and B.
2. Open valve C.
3. Drain the Truma AquaGo™ instant water heater (refer to "Draining the water and cleaning the water inlet filter" on page 12).
4. Flush the RV's water system with a suitable winterizing fluid according to the supplier's or RV manufacturer's guidelines.

Winterizing model AquaGo™ comfort plus

1. Close valves A, B and E.
2. Make sure that valve D remains in the closed position.
3. Open valve C.
4. Drain the Truma AquaGo™ instant water heater (refer to "Draining the water and cleaning the water inlet filter" on page 12).
5. Flush the RV's water system with a suitable winterizing fluid according to the supplier's or RV manufacturer's guidelines.
6. Close all faucets.
7. Open valve D.
8. Wait until winterizing fluid is leaving the drain line. Collect escaping fluid with a suitable vessel.
9. Close valve D.

AquaGo™ technical data

BTU/h (Nominal input rate)	20,000 – 60,000		
Fuel	LP gas (propane only)		
Fuel inlet pressure	10.5" – 14" wc 26.2 – 34.9 mbar		
Fuel manifold pressure	1.3" – 10" wc 3.2 – 24.9 mbar		
Nominal voltage	12 V DC (< 1 V _{pp})		
Power input			
AquaGo™ basic	< 1.5 A		
AquaGo™ comfort	< 2.5 A		
AquaGo™ comfort plus	< 2.5 A		
Water operating pressure	65 psi (4.5 bar) max.		
Standard water outlet temperature	120 °F (49 °C)		
Water volume	0.35 gallons (1.3 liter)		
Ambient temperature			
AquaGo™ basic	+32 °F...+104 °F (+5 °C...+40 °C)		
AquaGo™ comfort	-4 °F...+104 °F		
AquaGo™ comfort plus	(-20 °C...+40 °C)		
Dimensions (without flange and frame)			
	Width	Height	Depth
inch	12.5	12.5	15.5
mm	318	318	394
Dimensions of frame			
Size XS			
inch	15.1	15.5	0.8
mm	384	394	20.2
Standard			
inch	17.7	17.7	0.8
mm	450	450	20.2
Adapter			
inch	20.1	20.1	0.8
mm	510	510	20.2
Installation cutout and depth			
	Width	Height	Depth*
inch	12.8	12.8	17.7 >19.7**
mm	324	324	450 >500**
Weight unit without access door	(approx.) 34.2 lbs (15.5 kg)		
Weight access door standard and access door XS	(approx.) 2.9 lbs (1.3 kg)		
Weight access door adapter kit	(approx.) 5.5 lbs (2.5 kg)		

* Depending on application

** Recommended

TRUMA Gerätetechnik GmbH & Co. KG
("TRUMA")

"AquaGo" MANUFACTURER LIMITED WARRANTY

(September 2014)

This limited warranty pertains solely to the "AquaGo" (the "Product") manufactured by TRUMA and sold through its affiliates and dealers in North America.

TRUMA warrants subject to the below stated conditions that the Product will be free from defects in material and workmanship, and will perform in accordance with the technical specifications set forth in the description of the Product for a period of twelve (12) months for newly manufactured parts from the original date of purchase. The original purchaser is advised to register the Product within two (2) months of purchase with www.truma.net in order to receive an extended warranty of an additional twelve (12) months. This limited warranty shall only apply if the Product was properly installed according to the installation instructions provided and in compliance with applicable codes.

During the warranty period, TRUMA will repair or replace, at its own discretion and costs, the defective Product or parts or components of such Product reported to TRUMA and which TRUMA determines was defective due to a warranty defect. Costs of diagnosis for a warranty defect are borne by TRUMA. Other costs of diagnosis are not included in this warranty. At the discretion of TRUMA, the replacement of the Product or parts or components thereof (i) may be newly manufactured, (ii) may be assembled from new or serviceable used parts that are equivalent to new parts in performance, or (iii) may have been previously installed.

The customer shall not attempt to repair the Product or resolve the problem without the prior consent of TRUMA. Any attempt by the customer to repair the Product or resolve the problem without the prior consent of TRUMA will void this warranty.

This limited warranty does not cover any defects attributable in whole or in part to (i) non-TRUMA products and services and / or alterations of out-of-specification supplies, (ii) accidents, misuse, negligence or failure of the customer to follow instructions for the proper use, care and cleaning of the Product, (iii) damages caused in

gas pressure regulation systems due to foreign substances in the gas (i.e. oil, plasticisers), (iv) external factors (e.g., fire, flood, severe weather), (v) failure of proper transport packaging, or (vi) failure by the purchaser to comply with TRUMA's installation and user manual regarding the Product.

All warranty claims must be reported to TRUMA's authorized warranty service center in the United States: Truma Corp Service Center, **825 East Jackson Blvd., Elkhart, IN 46516, toll free: (855) 558-7862, fax. (574) 538-2426,** service@trumacorp.com, www.truma.net

The purchaser shall provide the following information regarding the potential warranty claim (i) serial number of the defective device, (ii) proof of purchase, (iii) purchaser's contact information.

EXCEPT AS EXPRESSLY STATED AND SET FORTH HEREIN, THERE ARE NO WARRANTIES OR REPRESENTATIONS, EXPRESS OR IMPLIED, CONCERNING THE PRODUCT AND NO SUCH WARRANTIES OR REPRESENTATIONS SHALL BE IMPLIED UNDER ANY APPLICABLE LAW, IN EQUITY OR OTHERWISE, INCLUDING WITHOUT LIMITATION, A WARRANTY OF MERCHANTABILITY, A WARRANTY OF FITNESS FOR A PARTICULAR PURPOSE, OR ANY OTHER WARRANTY WHICH MAY BE IMPLIED UNDER COMMON LAW OR UNDER THE UNIFORM COMMERCIAL CODE OF ANY STATE OR OTHER JURISDICTION OF THE UNITED STATES OF AMERICA.

Unless further limited herein, the entire liability of TRUMA and the customer's exclusive remedy for damages from any cause related to or arising out of a warranty defect, regardless of the form of action, whether in contract or in tort, will not exceed the amount of the purchase price for each purchase order for the Product which is the subject matter or directly related to the causes of action asserted.

Unless prohibited under applicable state law, in no event will TRUMA, its agents, subcontractors, affiliates, suppliers and employees be liable for (a) any incidental, indirect, special or consequential damages, including, but not limited to, loss of use, revenue, profits or savings, substitute rental or for any other reason, even if TRUMA knew or should have known of the possibility of such losses or damages, (b) claims, demands or actions against the customer by any person, except as provided by applicable law.

Maintenance

Repairs must be performed by a certified service technician. Truma recommends that the Truma AquaGo™ instant water heater be serviced annually by a certified service technician. Verify proper operation after servicing.

▲ WARNING

High temperatures or repair attempts while the gas supply is turned on may result in scalding injuries!

- Turn OFF the electrical power supply and the LP gas supply before starting maintenance and repair work.
- Never actuate the pressure relief valve as long as the Truma AquaGo™ instant water heater is still hot.

▲ CAUTION

Injuries caused by the Easy Drain Lever!

- Never actuate the Easy Drain Lever as long as the Truma AquaGo™ instant water heater is under water pressure and/or is still hot.

▲ CAUTION

Sharp edges can cause cuts and injury!

- Always wear protective gloves to avoid injuries from sharp edges during maintenance work.

Draining the water and cleaning the water inlet filter



- To keep the Truma AquaGo™ instant water heater fully functional, clean the water inlet filter at least once a year.

1. Remove the access door (refer to "Removing the access door" on page 7).
2. Switch off the Truma AquaGo™ instant water heater at the mode switch.
3. Open a hot water faucet and wait for cold water.
4. Turn OFF the water supply.
5. Leave the hot water faucet open in order to depressurize and vent the water system.

⚠ CAUTION

Injuries caused by the Easy Drain Lever!

When the Easy Drain Lever is folded out, it protrudes beyond the side wall of the vehicle.

- When walking past or stooping down, make sure that you and others have sufficient distance.

6. Open the latch with your thumb while pulling the Easy Drain Lever down as far as it will go.
7. Remove the water inlet filter as shown in Fig. 9 and clean it with clean water.
8. Inspect the O-rings on the water inlet filter for cracks.
Change the filter assembly (spare part, refer to "APPENDIX C – Spare Parts (all models)" on page 26) if there are cracks.

⚠ CAUTION

Danger of crushing/pinching of fingers when the Easy Drain Lever is closed!

- Never put fingers between Easy Drain Lever and water inlet filter or Latch.



- If during installation, it is difficult to install the filter cartridge, use a small amount of dish soap on the O-rings. Never use grease, because the O-rings are not resistant to grease.

9. Install the water inlet filter as shown in Fig. 9. Observe the correct installation position and close the Easy Drain Lever until it is locked by the latch.
You can hear a "clicking" sound as the Easy Drain Lever engages.
10. Insert and close the access door (refer to "Closing the access door" on page 7).

Decalcifying

- Only use approved substances to decalcify the Truma AquaGo™ instant water heater to avoid damage and the voiding of your warranty. Never use vinegar. Call your local AquaGo dealer or service provider or see www.truma.net for more information.
 - The use of non-Truma-approved substances for decalcification can cause chemical reactions and produce hazardous substances that could enter the drinking water supply.

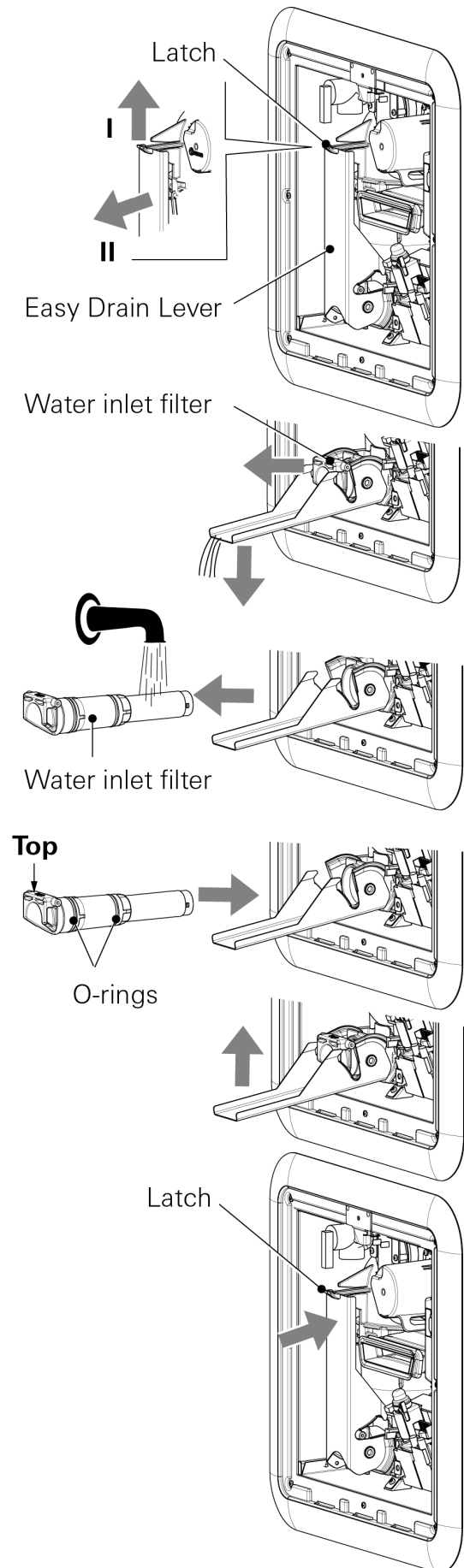

Fig. 9

Troubleshooting

Problem	Potential cause	Resolution
No hot water at the faucet	Gas supply is turned off or interrupted.	Check and/or turn on gas supply.
	LP gas tank is empty.	Refill/replace the gas tank.
	The Truma AquaGo™ instant water heater is switched off.	Switch on the Truma AquaGo™ instant water heater according to instructions (refer to "Operating procedures" on page 8).
	Fresh water supply is turned off.	Open the fresh water supply.
	Power supply to the Truma AquaGo™ instant water heater is switched off.	Switch on power supply to the Truma AquaGo™ instant water heater.
	Defect in the Truma AquaGo™ instant water heater.	LED 2 blinks red (refer to "APPENDIX A – Error Codes" on page 24) and contact a certified service technician if necessary.
Hot water temperature too low (<120 °F / 49 °C)	Gas flow to the Truma AquaGo™ instant water heater is too low (gas inlet pressure < 10.5" wc).	Consult vehicle documentation to determine if gas supply is capable of providing the necessary volume of gas for the Truma AquaGo™ instant water heater (refer to "AquaGo™ technical data" on page 11).
	Volume flow of hot water is too high and/or the temperature of cold water reaching the Truma AquaGo™ instant water heater is too low.	Turn down hot water at the faucet or in the shower in order to reduce volume flow. Potentially retrofit a volume flow throttle into the water system. This shall be performed only by a certified service technician.
	Too much lime deposits in the Truma AquaGo™ instant water heater.	Have the Truma AquaGo™ instant water heater decalcified by a certified service technician.
Water escaping at pressure relief valve	Water pressure in water system too high.	Adjust the water pump pressure. If the water pump pressure is still too high, replace the water pump. Install a pressure limiter at the fresh water supply. This shall be performed only by a certified service technician.
	Water cannot expand in the water system.	Contact the vehicle manufacturer about retrofitting a pressure compensation element.
	Lime or dirt under the pressure relief valve seat.	Slowly raise the test lever (Fig. 3 – 4a) to flush the water system and attempt to force dirt or foreign matter off of the pressure relief valve seat. Replace pressure relief valve. This shall be performed only by a certified service technician.
Water escaping at the water inlet filter	Lime or dirt under the O-ring seats.	Clean the O-rings and their corresponding sealing surfaces with clean water.

This page is intentionally left blank.

Installation Instructions

Read, observe, and follow these safety messages to avoid injuries during installation or operation.

Safety behavior and practices

- Installation and service must be performed by an authorized Truma recommended installer, service agency, or OEM. Improper installation, alteration, service, or maintenance can cause property damage, personal injury, or loss of life.
 - Do not attempt installation as a Do-it-Yourself project.
- Install in recreational vehicles (RVs) only.
 - Install the Truma AquaGo™ instant water heater on an exterior wall, with the access door opening to the outside.
 - Install the Truma AquaGo™ instant water heater in the shown orientation.
- Switch off the vehicle's on-board power supply during installation and when connecting the Truma AquaGo™ instant water heater.
- Close the vehicle's gas supply during installation and when connecting the Truma AquaGo™ instant water heater.
- Always wear protective gloves to avoid injuries from sharp edges during installation and maintenance work.
- Handle the Truma AquaGo™ instant water heater only by lifting or grabbing the metal casing or cover plate. Never lift or grab the Truma AquaGo™ instant water heater by any of its delicate interior components.
- Make sure that all combustion air is supplied from outside the RV. **DO NOT** draw air for combustion from occupied spaces.
- Make sure that all exhaust gases are directed outside of the RV.
 - Protect building materials from exhaust gases.
 - Never direct the exhaust gases to any outdoor enclosed spaces, such as a porch.
- Any alteration to the Truma AquaGo™ instant water heater or its controls can cause unforeseen serious hazards and will void the warranty.

- **DO NOT** alter the Truma AquaGo™ instant water heater for a positive grounding battery system.
- **DO NOT** shorten the power cable or remove the sticker that indicates polarity.
- **DO NOT** perform a hi-pot test on the Truma AquaGo™ instant water heater unless the electronic ignition system (circuit board) has been disconnected. A hi-pot test applies a very high voltage between two conductors.
- **DO NOT** use a battery charger to supply power to the Truma AquaGo™ instant water heater, even when testing.
- If the vehicle requires welding **DO NOT** connect the 12 Volt DC power to the Truma AquaGo™ instant water heater. Electrical welding will cause serious damage to the Truma AquaGo™ instant water heater controller.

United States and CANADA

This appliance must be installed in accordance with local codes or, in the absence of local codes, the Standard for Recreational Vehicles, ANSI A119.2/NFPA 501C or CAN/CSA-Z240 RV.

Selecting a suitable location

The Truma AquaGo™ instant water heater is designed to be installed on a floor or a fixed platform with access to water. Electrical connections are established at the back. Gas access is from the side.

The Truma AquaGo™ instant water heater is designed exclusively for installation on an outside wall of a RV.



- Installation of the water heater on the back of a trailer is not advised because of high pollution caused, e.g., by dirty and wet roads.

▲ WARNING

Risk of poisonous exhaust gases due to improper installation!

- Make sure that the Truma AquaGo™ instant water heater is installed as described below.

- DO NOT install the Truma AquaGo™ instant water heater in any location where the vent may be covered or obstructed when any door on the RV is opened or due to the design of the RV or due to special features of the RV such as slide-out, pop-up, etc.
- DO NOT install the Truma AquaGo™ instant water heater under any window, slide-out or opening into the RV in order to prevent exhaust gases from entering the RV.
- DO NOT install the heater in such a way that the cover plate is less than
 - 1 foot (30 cm) from each side and top of any window, slide-out or opening into the RV,
 - 6 feet (1.8 m) from any mechanical air supply inlet o
 - 3 feet (91 cm) from any gas tank connection or ventilation.
- Maintain a minimum clearance from combustible materials on sides, top, floor and rear (0 inches).
- Provide room for access to rear of heater for servicing.

Preparing for installation

⚠ CAUTION

Sharp edges can cause cuts and injury!

- Always wear protective gloves to avoid injuries from sharp edges during installation work and while handling the Truma AquaGo™ instant water heater.

Preparing the installation site

1. Make sure that the Truma AquaGo™ instant water heater is in contact with the vehicle floor or a platform with adequate weight-bearing capacity when installed.
2. To install on carpeted area, install a metal or wood panel under the Truma AquaGo™ instant water heater that extends at least 3" (7.6 cm) beyond the width and depth of the appliance.
3. If escaping water may damage components or the vehicle, install a collection pan below the Truma AquaGo™ instant water heater. Direct the flow of water from the pan to outside the vehicle.

4. Make sure that the front edge of the opening is surrounded by a solid frame to firmly anchor the Truma AquaGo™ instant water heater. If needed, build an appropriate frame (Fig. 10) with the following dimensions:

Width	a =	12.75" (324 mm)
Height	b =	12.75" (324 mm)
Depth	c =	>17.7" (450 mm)

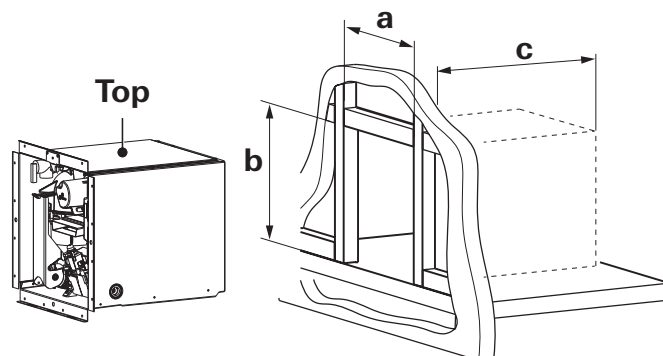

Fig. 10



- The required depth "c" depends on how the water hoses, electrical connection cable, and gas line are installed. The depth "c" must be determined for the particular situation before installation.
- The corners of the rough opening must be right angles. The exterior wall opening must be the same dimensions with no rounded corners.

5. Make sure you have suitable screws ready:
 - In order to securely fasten the water heater and the cover plate, the screws must be suitable for the chosen frame material and have a diameter of 0.138" (#6) to 0.164" (#8).
 - Use pan head screws.
 - Never use countersunk screws.
 - For the length of the screws follow the screw manufacturer's guidelines.

Preparing the gas connection

The gas line is guided into the Truma AquaGo™ instant water heater from the side. A hole with a grommet is provided in the unit casing for this purpose.

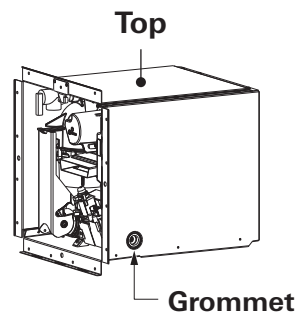

Fig. 11

The gas connection (SAE 45° Flare Male – SAE J512, 5/8" – 18) is located inside the appliance.

▲ WARNING

Risk of explosion due to improper installation of the gas connection!

- Make sure that the operating pressure of the gas supply corresponds to the operating pressure of the Truma AquaGo™ instant water heater (10.5" – 14" wc (26.2 – 34.9 mbar)).
- Make sure that the gas line to the Truma AquaGo™ instant water heater is a rigid (metal) 3/8" pipe. Do not use flexible connectors.

1. Make sure that the gas line to the Truma AquaGo™ instant water heater is able to supply the maximum required quantity of gas ($\geq 60,000$ BTU/h).
2. Consider the space needed to lay the gas line and integrate the Truma AquaGo™ instant water heater when planning the installation space.
3. Guide the gas line into the installation space so that the appliance may be removed and reinstalled if service or repair are needed.
4. Allow sufficient length and flexibility in the gas line for connection or disconnection of the gas line.
5. Reduce the number of separation points in the gas line to the technically required number.
6. Avoid separation points in the gas line in spaces used by people.
7. Ensure that the gas connection from the vehicle is in place before installing the appliance.

Preparing the water connection

All water connections at the Truma AquaGo™ instant water heater are 1/2" NPT male connections.



- The network of lines must be planned before installation (refer to "Connection diagrams" on page 19).

1. Use a suitable connector with a seal for establishing the water connection to the Truma AquaGo™ instant water heater.
2. Use of flexible water hoses of at least 1/2" diameter is preferred.
3. Make sure that all water hoses are installed without kinks.

4. Make sure that the water connections from the vehicle are in place before installing the Truma AquaGo™ instant water heater.

Preparing the 12 V DC electrical connection

All electrical connections must be made in compliance with all national, regional or local electrical codes.

In the absence of local codes and regulations, refer to the latest edition of the National Electrical Code ANSI/NFPA No. 70. In Canada, the electrical installation shall conform with CSA standard CSA C22.2 No. 148/Z240.6.2 Electrical Requirements for Recreational Vehicles and CSA C22.1 Canadian Electrical Code Part 1 when installing the appliance in RVs.

▲ WARNING

Risk of a short circuit and hazardous situations due to improper installation of the electrical connection!

- Use only insulated terminals for all electrical connections.
- The positive line must be fused with a 5 – 10 A fuse near the battery's positive terminal.
- The power supply cable must have a diameter of at least:
 - AWG 16 for up to 40 ft length (bidirectional)
 - AWG 14 for up to 66 ft length (bidirectional)

1. Establish the 12 Volt DC electrical connections according to the Connection diagram—refer to "Electrical connection for all models" on page 20).
2. To ensure reliable operation:
 - Provide a constant voltage supply.
 - Filter any AC spikes or voltage surges.

Connection diagrams



- The drawings are not intended to describe a complete system. It is up to the certified service technician to determine the necessary components for and configuration of the particular system being installed (for example an additional surge damper).
- The drawings do not imply compliance with state or local code requirements or regulations. It is the certified service technician's responsibility to make sure that the installation is in full compliance with all state or local code requirements or regulations.

Model AquaGo™ basic / AquaGo™ comfort

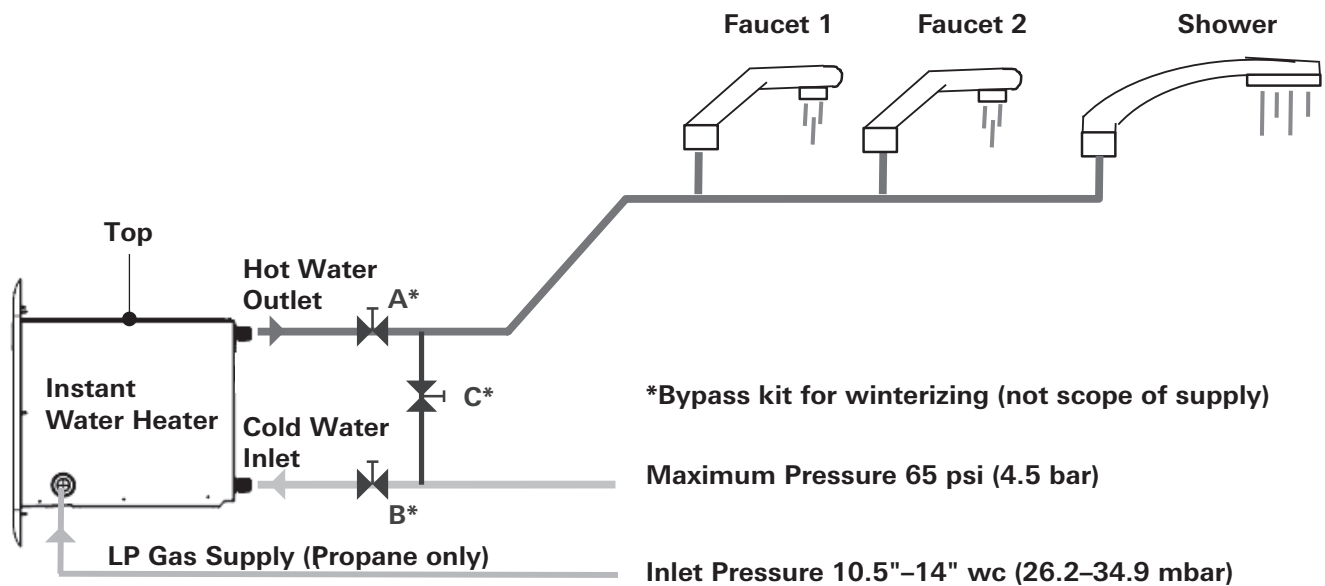

Fig. 12

Model AquaGo™ comfort plus

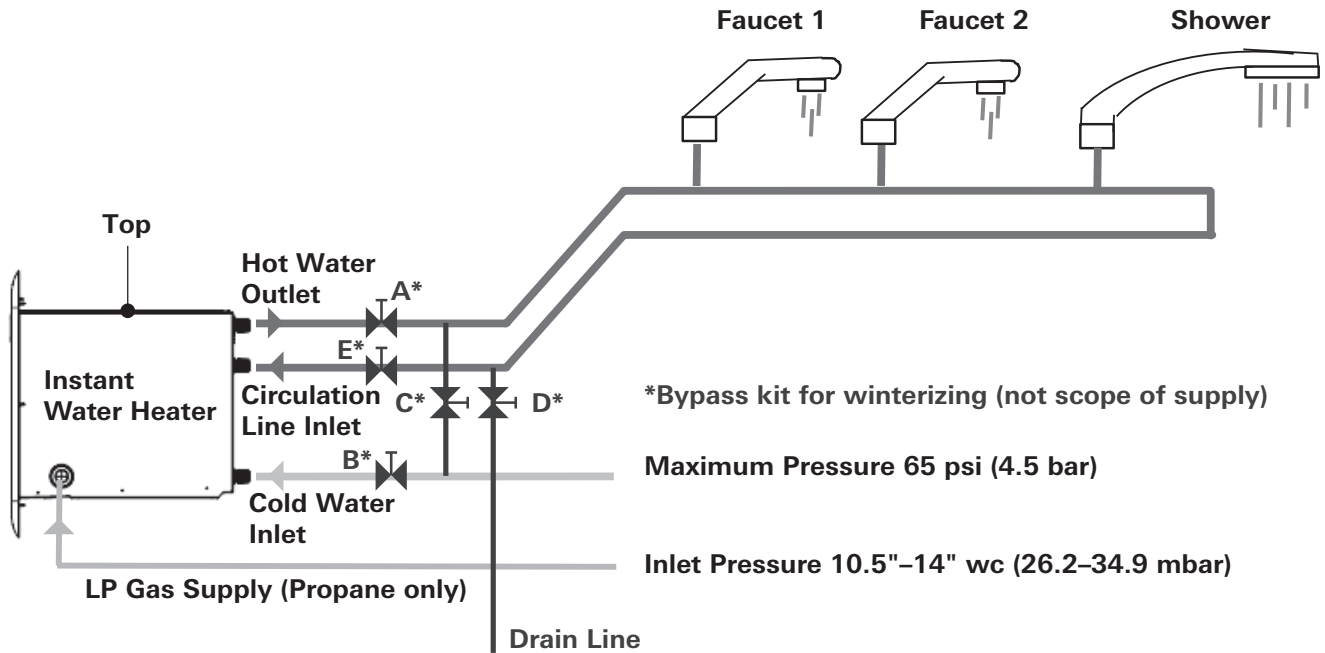

Fig. 13

Electrical connection for all models

Maximum length of the power supply cable (including cables for the optional switch):

- for AWG 16: max. 40 feet (12 m) (bidirectional)
- for AWG 14: max. 66 feet (20 m) (bidirectional)

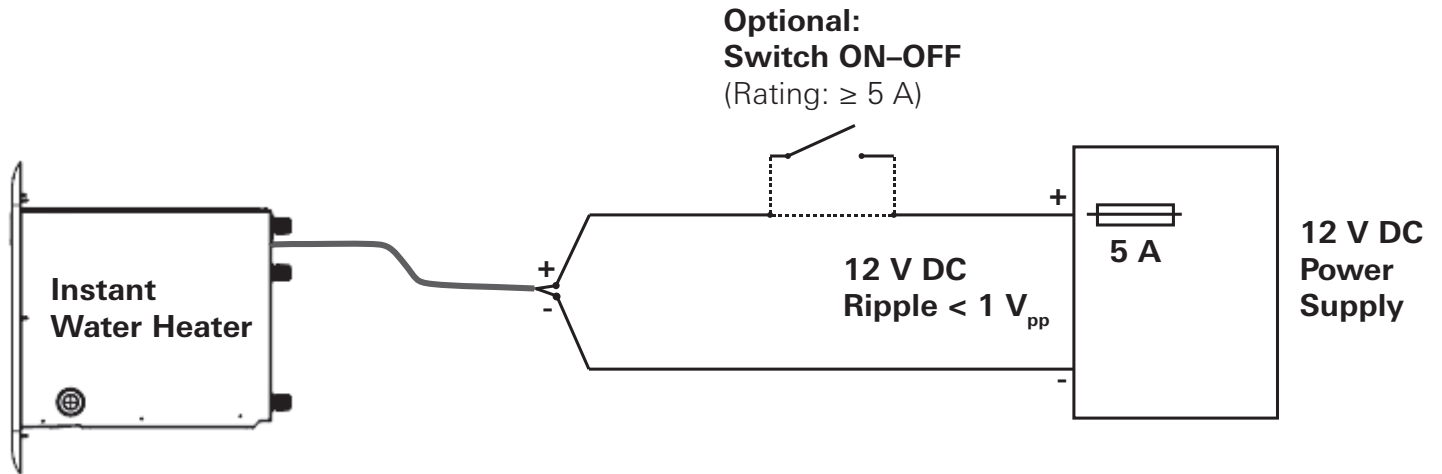

Fig. 14

Installing the Truma AquaGo™ instant water heater

Before installation, read the chapter refer to "Preparing for installation" on page 17 and the following.

⚠ CAUTION

Sharp edges can cause cuts and injury!

- Always wear protective gloves to avoid injuries from sharp edges during installation work and while handling the Truma AquaGo™ instant water heater.

1. Slide the appliance carefully into the installation space until the installation frame makes contact.
2. Make sure that the gas line connects perpendicularly to the Truma AquaGo™ instant water heater's gas connection and without tension.
3. If the connection is OK, push the gas line back. It will be connected in a later step.
4. The Truma AquaGo™ instant water heater must be installed with a watertight seal with the outer skin of the vehicle.

NOTICE

Damage to the Truma AquaGo™ instant water heater and/or the RV!

- Do not use adhesive sealing material (e.g. silicone) for the watertight seal. Otherwise damage may occur when the appliance is moved when performing service.

To achieve the watertight seal:

- Pull the Truma AquaGo™ instant water heater out ≈ 2" (5 cm).
- Apply an adequate amount of watertight sealing material to the entire flange area of the installation frame and at the corners, see grey marking in Fig. 15.
- Slide the Truma AquaGo™ instant water heater carefully into the installation space until the installation frame makes contact.

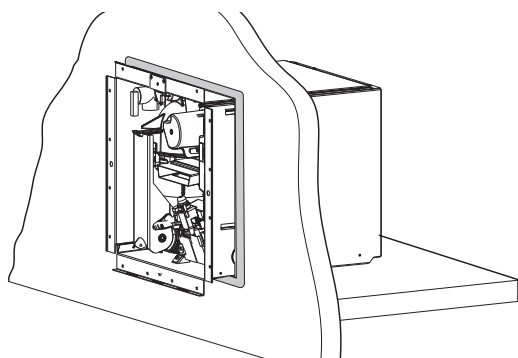

Fig. 15

5. Screw the Truma AquaGo™ instant water heater into the vehicle's prepared frame with 14 screws. The screws must be suitable for the chosen frame material and have a diameter of 0.138" (#6) to 0.164" (#8).
6. Make sure that the unit casing corners are 90 degrees square so that the cover plate/ access door fits properly.

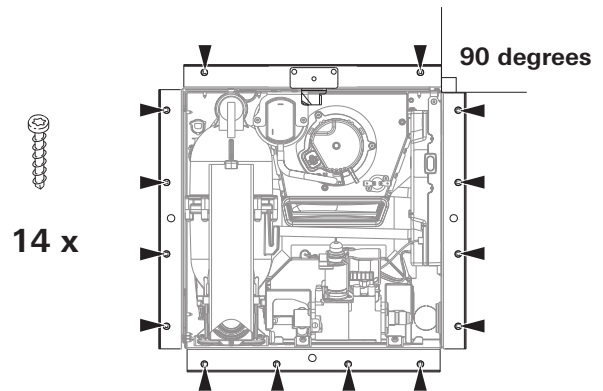

Fig. 16

7. Immediately remove all excess sealing material.

⚠ WARNING

Risk of death of poisoning and significant damage to the RV due to exhaust gas and leaking water!

- Make sure that there is a tight seal and that no exhaust gas or water can enter the RV.

8. Check and make sure that there is a tight seal.
9. Fasten the cover plate to the Truma AquaGo™ instant water heater (see Fig. 17):
 - Position the cover plate.
 - Screw the cover plate only loosely. Start with screw 1.
 - Align the cover plate.
 - Uniformly tighten all 8 screws.

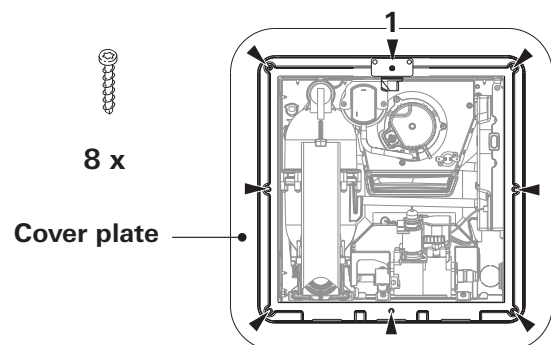

Fig. 17

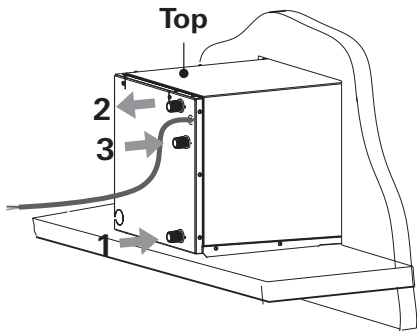

Fig. 18

NOTICE

Damage to the Truma AquaGo™ instant water heater and the connections!

- Make sure that no gas lines, water hoses, or electrical lines are kinked or pinched.

NOTICE

Damage to the Truma AquaGo™ instant water heater and the water connections!

- When establishing the water connections, observe the installation instructions and torques specified by the manufacturer.

10. Connect the hose for cold water (1) at the bottom of the Truma AquaGo™ instant water heater.
11. Connect the hose for hot water (2) at the top of the Truma AquaGo™ instant water heater.
12. Model AquaGo™ comfort plus only: Connect the hose for the circulation line (3).
13. Check all connections for water leaks.
 - Repair leaks as needed.
 - Repeat check for water leaks and take any necessary steps to repair the leaks at all water connections.
14. Connect the electrical lines with the proper polarity to the 12 V DC power supply (refer to "Electrical connection" on page refer to "Electrical connection for all models" on page 20). Install a 5 A fuse (see Fig. 14).

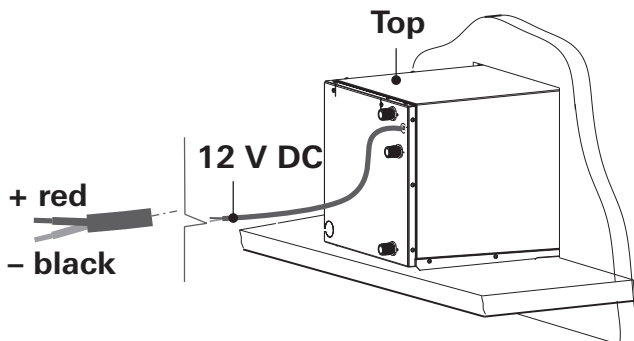

Fig. 19

Gas connection

Connecting the gas line

▲ WARNING

Risk of explosion or poisoning due to improper installation!

- Permit only a certified service technician to perform installation.

NOTICE

Functional disturbances in the water heater or damage to the gas valve due to dirt, chips, etc. in the gas line!

- Before connecting to the appliance, make sure that the gas line is free of dirt, chips, etc.

1. Make sure that the manual shut-off valve in the gas line of the appliance is closed.

▲ WARNING

Risk of explosion or poisoning due to damaged grommet and/or gas line!

- Make sure that the gas line is centered and tension-free when it enters the grommet so that the gas line will not abrade the grommet.
- Make sure that the gas line has an SAE 45° Flare Female connector.

2. Guide the prepared gas line through the grommet.

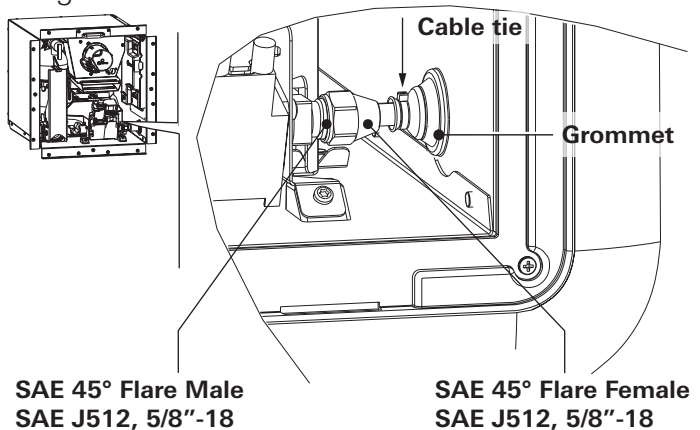

Fig. 20

NOTICE**Damage of the flare fitting!**

The flare fitting is a dry seal.

- Never use pipe dope on the flare fitting.

3. Screw the gas line's union nut (wrench size 3/4") onto the Truma AquaGo™ instant water heater's gas connection so it is finger-tight.

NOTICE**Gas valve may be damaged during tightening!**

- Use a second wrench to counterhold at the square end (wrench size 11/16").

4. Use a torque wrench to tighten the union nut (nominal torque 15 lb-ft / 20 Nm).

⚠ WARNING**Risk of poisoning and/or explosion!**

Improper tightening of the cable tie could result in gas/exhaust entering the RV.

- Close the cable tie so that the grommet tightens the gas pipe passage.



- A cable tie is provided with the Truma AquaGo™ instant water heater. You will find it fixed to the gas valve.

5. Put a cable tie around the grommet and tighten it (see Fig. 20).

Checking for gas leaks

⚠ WARNING**Risk of death and personal injury through fire and/or explosion!**

- DO NOT use matches, candles or other sources of ignition when checking for gas leaks.
- After the gas supply is connected, check for gas leaks at all gas connections. Use a gas leak detection liquid.

1. Turn OFF the electrical power supply.
2. Turn on the gas.
3. Check the Truma AquaGo™ instant water heater and all gas connections for gas leaks with leak detection liquid. Bubbles indicate a gas leak that must be repaired.
4. Repair gas leaks as needed.
5. Repeat check for gas leaks at all gas connections.

Functional check

1. Bring the Truma AquaGo™ instant water heater into operation (refer to "Placing Truma AquaGo™ instant water heater in operation" on page refer to "Placing Truma AquaGo™ instant water heater in operation" on page 8).
 2. Check the Truma AquaGo™ instant water heater for proper functionality.
 3. Provide operating and installation instructions to the vehicle owner.
- The Truma AquaGo™ instant water heater is now ready for normal operation and use.

APPENDIX A – Error Codes

If the Truma AquaGo™ instant water heater malfunctions LED 2 (refer to “Overview / Designation of parts” on page 2) will blink to indicate the malfunction. There are short and long intervals of blinking. The blinking will repeat every 3 seconds.

1. Write down the blinking intervals and check the list below.
2. Reset the Truma AquaGo™ instant water heater:
 - Switch off the Truma AquaGo™ instant water heater.
 - Wait 5 seconds.
 - Switch the Truma AquaGo™ instant water heater on again.
3. If an error code is still displayed, contact an authorized Truma service center.

Error code	Blink code s =short= 0 l = long= 1	Error	Description
1	s,s,s,s,s,s,l	Flame not detected	There is a flame-detection error at the burner because the flame was not detected after release of gas and ignition. Important: The system indicates this error only after three attempts at intervals of approximately 30 seconds.
2	s,s,s,s,s,s,l,s	Error at over temperature switches (EOS, BOS)	The exhaust over temperature switch (EOS) or burner over temperature switch (BOS) is open/unplugged.
3	s,s,s,s,s,s,l,l	Error at exhaust pressure switch (EPS)	The EPS did not close when the flue fan was actuated because the fan did not push enough air through the exhaust channel. A cause could be, e.g., blocking of the exhaust channel or a faulty switch. OR The EPS is closed even though the flue fan is not running. Cause is a defective EPS or flue fan.
4	s,s,s,s,s,l,s,s	Error at water over temperature switch (WOS)	The WOS opened at a water temperature of over 185 °F (85 °C).
5	s,s,s,s,s,l,s,l	Flame detected at incorrect time	There is an error in flame detection of the burner because the flame was detected – before ignition or – before the release of gas or – after the gas was switched off.
6	s,s,s,s,s,l,l,s	Error in the safety circuit for gas valve	There is a heating request but gas cannot be released. One of the switches WOS, EOS, BOS, EPS is open/unplugged.
7	s,s,s,s,s,l,l,l	Error of burner MCU internal RAM	Error detected in the burner MCU's internal safety monitoring feature (safety variables are no longer correct or RAM/STACK was overwritten by mistake).
8	reserved		
9	s,s,s,s,l,s,s,l	Malfunction of water outlet temperature sensor WOT	Water outlet temperature sensor WOT – has a short circuit or – is open/unplugged.
10	s,s,s,s,l,s,l,s	Error in the safety circuit	There is a heating request but gas is not released because a valve-actuation signal was not activated.
11	s,s,s,s,l,s,l,l	Error of MCU watchdog gas release	There is a heating request but the MCU watchdog does not release the gas path.
12	s,s,s,s,l,l,s,s	Internal error	
13	s,s,s,s,l,l,s,l	Short circuit shut-off valve	Short circuit detection in the gas valve (shut-off part) detected a current > 800 mA and shut off.
14 – 19	reserved		
20	s,s,s,l,s,l,s,s	Malfunction of water inlet temperature sensor WIT	Water inlet temperature sensor WIT – has a short circuit or – is open/unplugged or – the temperature of the sensor is colder than 14 °F (-10 °C).
21	s,s,s,l,s,l,s,l	Malfunction of circulation line temperature sensor WCT	Circulation line temperature sensor WCT – has a short circuit or – is open/unplugged or – the temperature of the sensor is colder than 14 °F (-10 °C).
22	s,s,s,l,s,l,l,s	Malfunction of gas valve, modulation section	Error at gas valve, modulation level, because - the modulator has a short circuit or - is open/unplugged.
23	s,s,s,l,s,l,l,l	Voltage is too high	The main power supply's voltage detector measured a voltage level of >16.4 V.
24	s,s,s,l,l,s,s,s	Voltage is too low	The main power supply's voltage detector measured a voltage level of <10 V.
25	s,s,s,l,l,s,s,l	Flue fan current consumption error	The current detector for the flue fan has measured a current outside the permitted limits.
26	s,s,s,l,l,s,l,s	Circulation pump current consumption error	The current detector at the circulation pump has measured a current outside the permitted limits.
27	s,s,s,l,l,s,l,l	Water circulation pump is running dry.	The circulation pump does not generate water flow. The water system may not be filled or not sufficiently vented. The circulation pump tries to generate a water flow every 30 s (if successful, the error is reset).

APPENDIX B – Functional Diagram

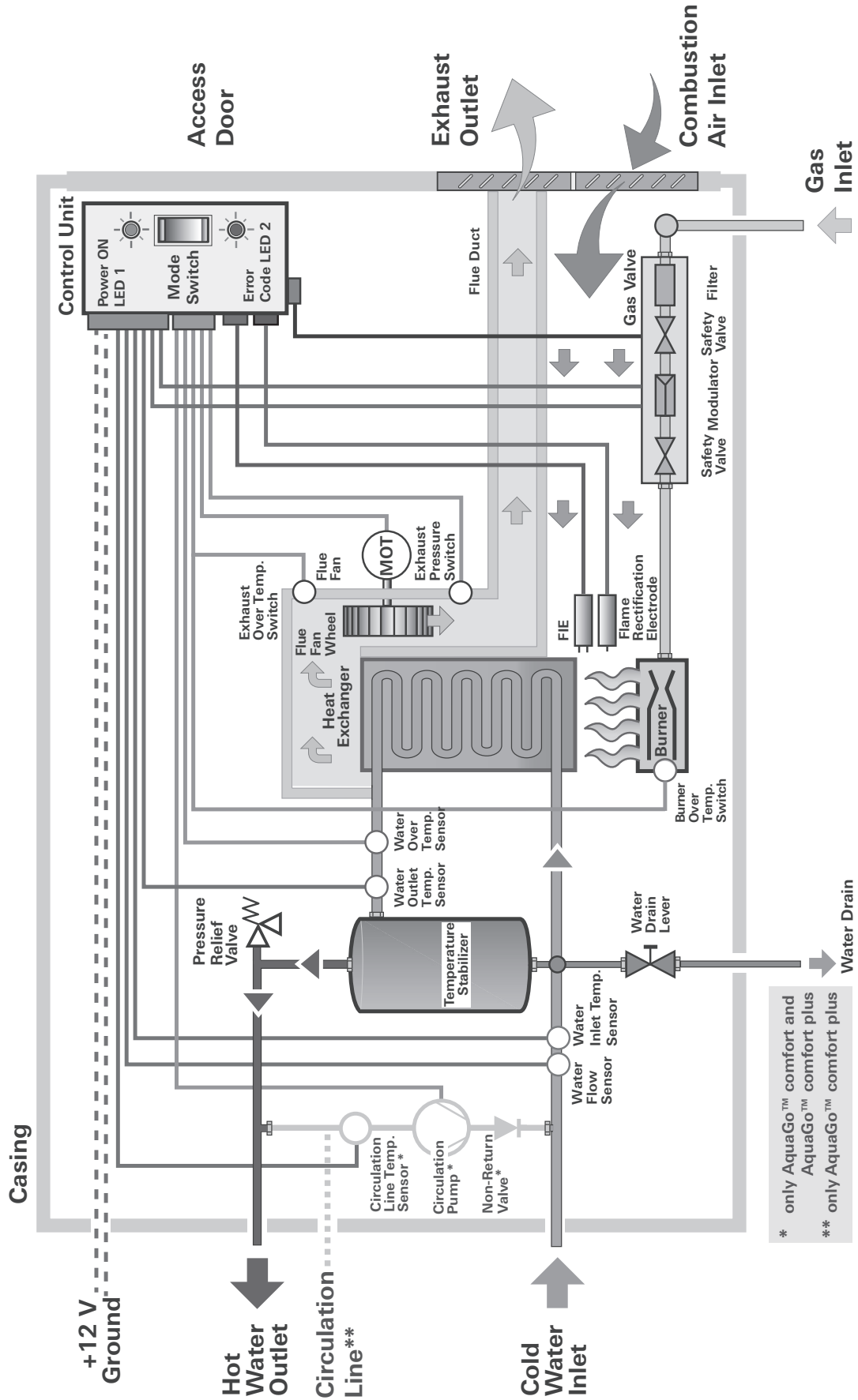

Fig. 21

APPENDIX C – Spare Parts (all models)

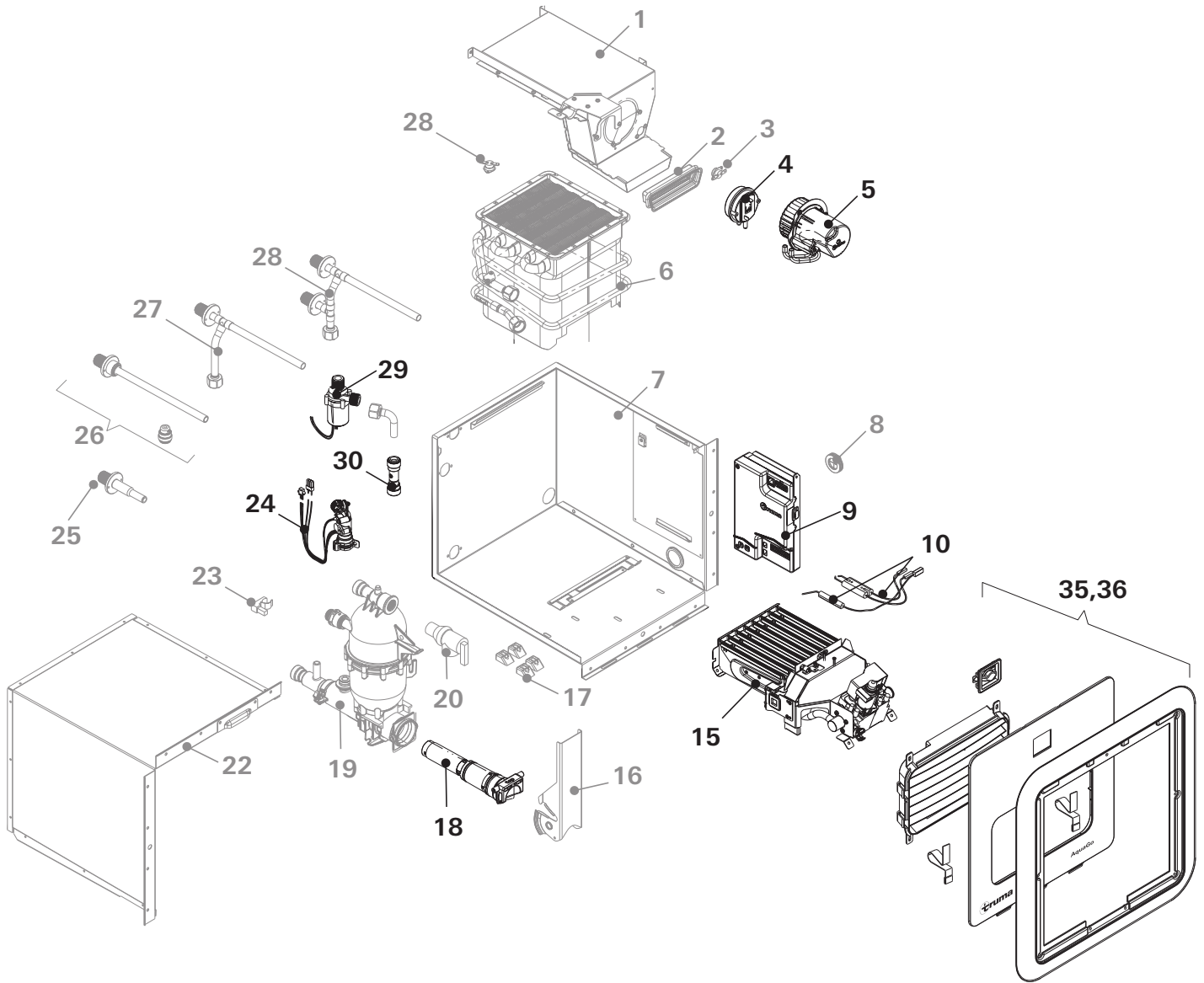

Fig. 22

Item Ref.	Part no.	Component
1	NYA	
2	NYA	
3	NYA	
4	77000-90100	Exhaust Pressure Switch
5	77000-90200	Flue Fan Assembly
6	NYA	
7	NYA	
8	NYA	
9	77000-90300	Control Unit Assembly
10	77000-91300	Electrodes
11	NYA	
12	NYA	
13	NYA	
14	NYA	
15	77000-90400	Burner Assembly
16	NYA	
17	NYA	
18	77000-90800	Filter Assembly
19	NYA	

Item Ref.	Part no.	Component
20	NYA	
21	-	-
22	NYA	
23	NYA	
24	77000-90500	Flow Sensor Assembly
25	NYA	
26	NYA	
27	NYA	
28	NYA	
29	77000-90600	Circulation Pump
30	77000-90700	Non-Return Valve Assembly
31	NYA	
32	NYA	
33	NYA	
34	NYA	
35	77000-01	Access Door Standard
36	77100-01	Access Door Adapter (not shown)
37	77200-01	Access Door XS (not shown)
-	-	-

APPENDIX D – Electrical Connection Diagram

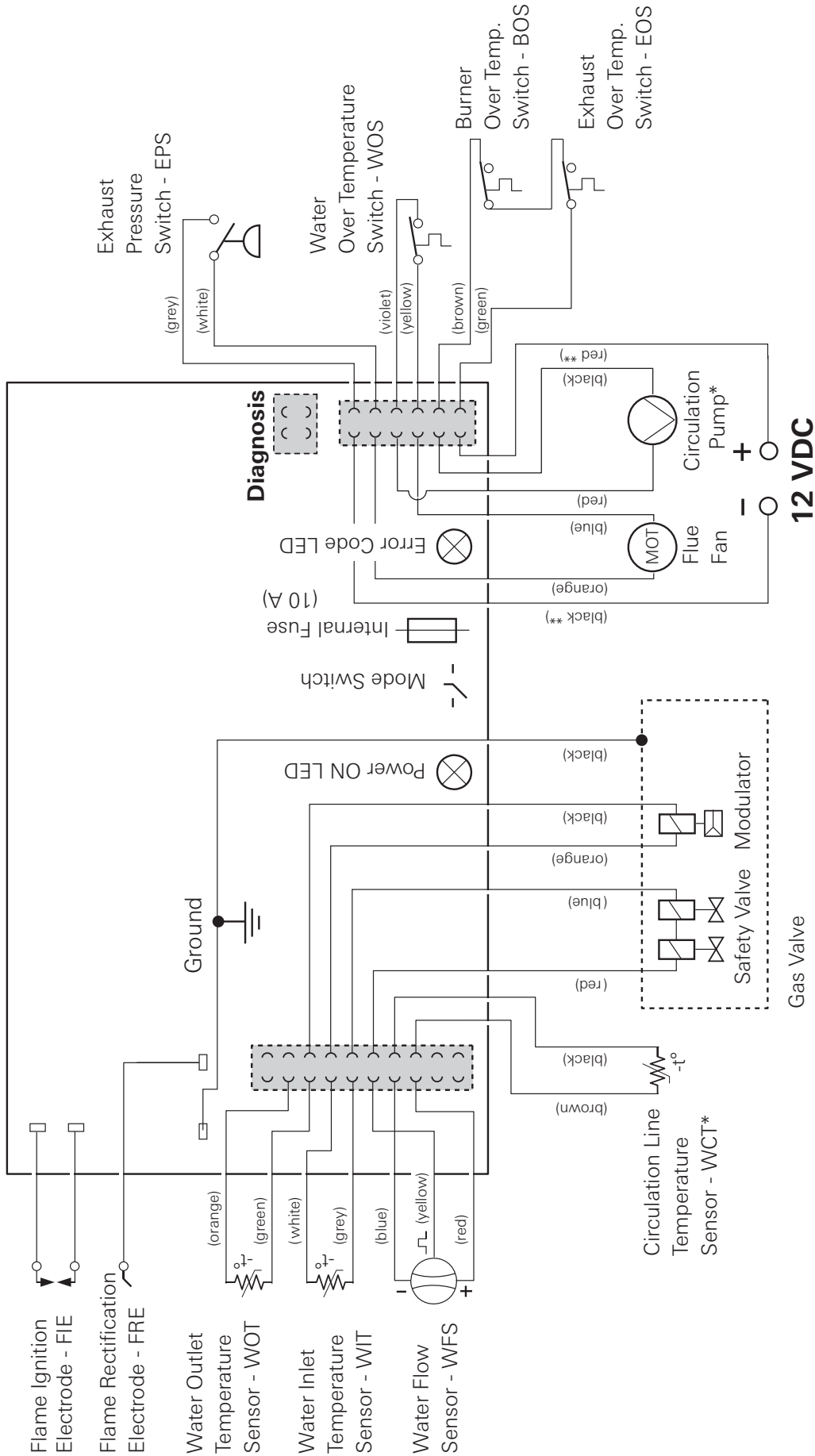

Fig. 23

If any of the original wire as supplied with the water heater must be replaced, it must be replaced with wire AWG# 18 (** AWG# 16) - 105 °C - UL1015, or its equivalent.

* only AquaGo™ Comfort and AquaGo™ Comfort Plus



In case you encounter any problems, please contact the Truma Service Center at 855-558-7862 or one of our authorized service partners. For details see www.truma.net.

Please have the model number and serial number (on water heater's type plate) handy when you call.

Manufacturing

Truma Gerätetechnik GmbH & Co. KG
Wernher-von-Braun-Straße 12
D - 85640 Putzbrunn
Germany
www.truma.com

Sales

Truma Corp
825 East Jackson Blvd.
Elkhart, IN 46516
USA
Toll Free 1-855-558-7862
Fax 1-574-538-2426
service@trumacorp.com
www.truma.net